

Electrical characteristics at Standard Test Conditions(STC)

Module Type	CSUN360-72M	CSUN355-72M	CSUN350-72M	CSUN345-72M
Maximum Power - Pmax (W)	360	355	350	345
Open Circuit Voltage - Voc (V)	47.3	47.1	46.9	46.7
Short Circuit Current - Isc (A)	9.67	9.57	9.49	9.38
Maximum Power Voltage - Vmpp (V)	38.6	38.4	38.2	38
Maximum Power Current - Imp (A)	9.33	9.24	9.17	9.09
Module Efficiency	18.59%	18.33%	18.07%	17.81%

Standard Test Conditions (STC): irradiance 1,000 W/m²; AM 1.5; module temperature 25°C. Tolerance of Pmp: 0~+3%.

Measuring uncertainty of power: ±3%. Certified in accordance with IEC 61215, IEC 61730-1/2 and UL 1703.

Electrical Characteristics at Normal Operating Cell Temperature(NOCT)

Module Type	CSUN360-72M	CSUN355-72M	CSUN350-72M	CSUN345-72M
Maximum Power - Pmax (W)	269	265	261	258
Open Circuit Voltage - Voc (V)	44.2	44	43.8	43.6
Short Circuit Current - Isc (A)	7.8	7.72	7.65	7.56
Maximum Power Voltage - Vmpp (V)	36.7	36.6	36.5	36.4
Maximum Power Current - Imp (A)	7.32	7.25	7.19	7.11

Normal Operating Cell Temperature(NOCT) : irradiance 800W/m²; wind speed 1 m/s ; cell temperature 45°C; ambient temperature 20°C.

Measuring uncertainty of power: ±3%. Certified in accordance with IEC 61215, IEC 61730-1/2 and UL 1703.

Temperature Characteristics

NOCT	45°C (±2°C)	Maximum System Voltage [V]	1000
Voltage Temperature Coefficient	-0.29%/K	Series Fuse Rating [A]	15
Current Temperature Coefficient	+0.05%/K		
Power Temperature Coefficient	-0.39%/K		

Maximum Ratings

Material Characteristics

Dimensions	1956×990×50mm (L×W×H)
Weight	22.3kg
Frame	Anodized aluminum profile
Front Glass	White toughened safety glass, 3.2 mm
Cell Encapsulation	EVA (Ethylene-Vinyl-Acetate)
Back Sheet	Composite film
Cells	6×12 pieces monocrystalline solar cells series strings (156mm×156mm)
Junction Box	Rated current≥13A, IP≥67, TUV&UL
Cable&Connector	Length 900 mm, 1×4 mm ² , compatible with MC4, Model Number: PV-G 156

Packaging

Dimensions(L×W×H)	1990×1120×112mm	Temperature Range	-40 °C to + 85 °C
Container20'	210	Withstanding Hail	Maximum diameter of 25 mm with impact speed of 23 m·s ⁻¹
Container40'	504	Maximum Surface Load	5,400 Pa
Container40'HC	552	Application class	class A
		Safety class	class II

System Design

Dimensions

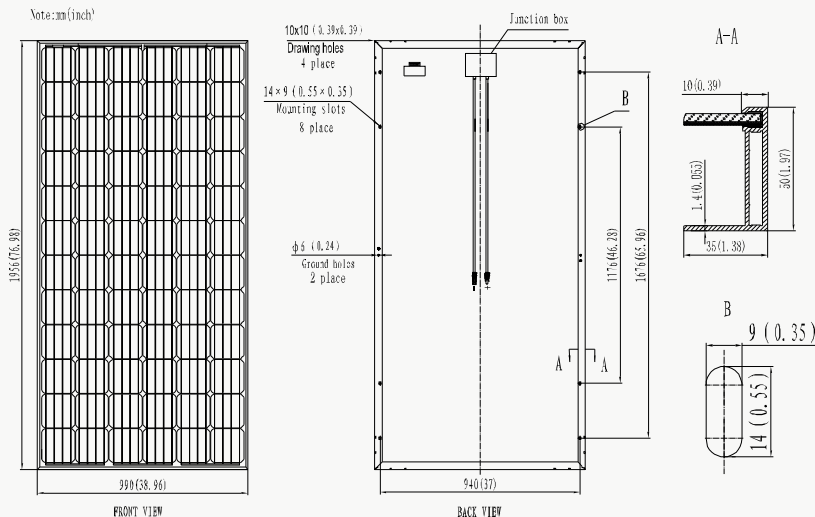

IV-Curves

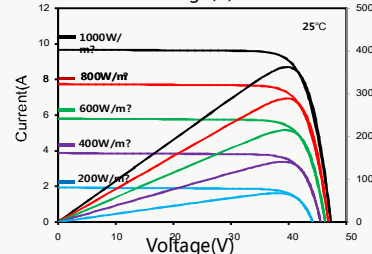
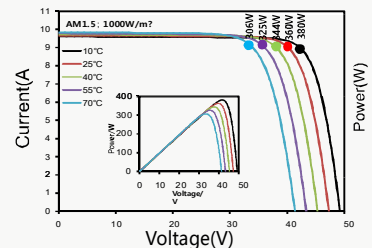

Excellent performance under weak light condition.